

速度调节阀 WNS系列

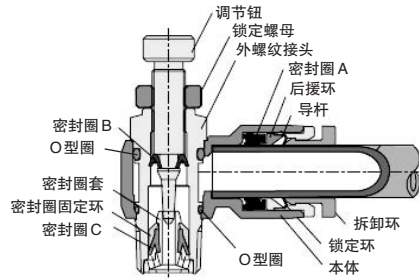
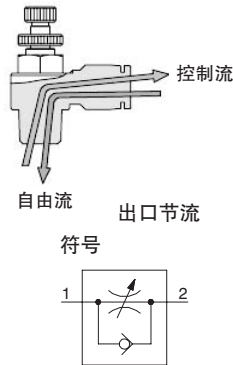

特长

- ◆ 最适合于小型气缸的小型设计
- ◆ 可以容易的进行低流量区的速度控制
- ◆ 标准采用PBT树脂

规格

	单位	
使用流体		压缩空气
使用温度范围	℃	0 ~ 60
使用压力范围	MPa	0 ~ 0.9
适用软管		聚氨酯软管

注)使用压力为温度20℃时的数值。

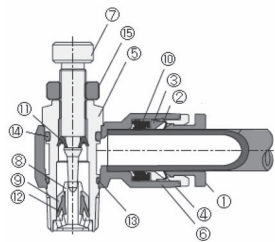

零件 No.	零件名称	材质	零件 No.	零件名称	材质
①	拆卸环	POM(聚甲醛)	⑨	密封圈固定环	黄铜
②	导杆	铸锌	⑩	密封圈A	NBR(丁腈橡胶)
③	后援环	铸锌	⑪	密封圈B	NBR(丁腈橡胶)
④	锁定环	SUS(不锈钢)	⑫	密封圈C	NBR(丁腈橡胶)
⑤	外螺纹接头	黄铜	⑬	O型圈	NBR(丁腈橡胶)
⑥	本体	PBT(聚对苯二甲酸丁二醇酯)	⑭	O型圈	NBR(丁腈橡胶)
⑦	调节钮	黄铜	⑮	锁定螺母	铝
⑧	密封圈套	黄铜			

型号

订购方式 _____

注)1个可以起订。

WNSE - 06 - 01 C - O

适用软管外径			
04:	4mm	10:	10mm
06:	6mm	12:	12mm
08:	8mm		

WNSE:	弯头型
WNSS:	万向型
WNSF:	直通型

O:	出口节流(调节钮镀金)
无记号:	标准型
C:	小型

M3:	M3 × 0.5	02:	R1/4
M5:	M5 × 0.8	03:	R3/8
01:	R1/8	04:	R1/2

注意

- 速度调节时把所有的速度调节针都关闭，然后慢慢的打开进行调节。如果调节针是开着的，执行元件有突然弹出来的可能性。调节后请务必用锁定螺母把调节阀固定。

- 方向型请不要在长时间回转的环境下使用。

- 接头部已经卷有密封带。密封带通常可以再次使用2 ~ 3回。

弯头型

(mm)

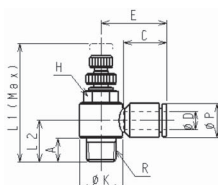

型号	A	C	φD	E	H	φK	L1 (Max)	L2	φP	R (外螺纹)	净量 (g)
WNSE04-M5-O	3.5	14.5	4	18.5	8.0	10.0	31.0	10.7	9.0	M5 × 0.8	8.1
WNSE04-01-O	8.0	14.5		21.0	10.0	14.4	39.8	14.0	9.0	R1/8	17.5
WNSE06-M5-O	3.5	15.2		6	21.0	8.0	10.0	31.0	10.7	11.4	M5 × 0.8
WNSE06-01-O	8.0	15.2	22.1		10.0	14.4	39.8	14.0	11.4	R1/8	18.2
WNSE06-02-O	11.0	15.2	24.2		14.0	18.4	47.4	18.5	11.4	R1/4	35.4
WNSE08-01-O	8.0	17.8	8	25.5	10.0	14.4	39.8	15.0	13.6	R1/8	19.1
WNSE08-02-O	11.0	17.8		27.8	14.0	18.4	47.4	18.5	13.6	R1/4	36.6
WNSE08-03-O	13.0	17.8		29.0	19.0	22.0	53.7	21.0	13.6	R3/8	64.5
WNSE10-02-O	11.0	19.4	10	29.5	14.0	18.4	47.4	20.5	16.3	R1/4	39.6
WNSE10-03-O	13.0	19.4		30.3	19.0	22.0	53.7	22.7	16.3	R3/8	67.8
WNSE10-04-O	16.5	19.4		33.0	24.0	28.0	59.3	25.6	16.3	R1/2	98.7
WNSE12-03-O	13.0	22.5	12	35.8	19.0	22.0	53.7	24.1	19.7	R3/8	70.6
WNSE12-04-O	16.5	22.5		38.8	24.0	28.0	59.3	27.5	19.7	R1/2	101.6

万向型

(mm)

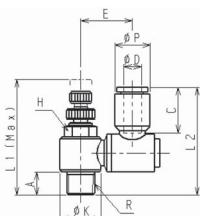

型号	A	C	φD	E	H	φK	L1 (Max)	L2	φP	R (外螺纹)	净量 (g)
WNSS04-M5-O	3.5	14.5	4	15.9	8.0	10.4	30.3	33.0	10.4	M5 × 0.8	8.9
WNSS04-01-O	8.0	14.5		18.1	10.0	10.4	39.8	36.5	10.4	R1/8	24.1
WNSS06-M5-O	3.5	15.9		6	15.9	8.0	10.4	30.3	33.6	12.4	M5 × 0.8
WNSS06-01-O	8.0	15.9	18.1		10.0	14.4	39.8	37.0	12.4	R1/8	24.8
WNSS06-02-O	11.0	15.9	20.1		14.0	18.4	47.4	41.0	12.4	R1/4	45.2
WNSS08-01-O	8.0	17.8	8	18.1	10.0	14.4	39.8	40.0	14.4	R1/8	41.9
WNSS08-02-O	11.0	17.8		20.1	14.0	18.4	47.4	43.0	14.4	R1/4	41.9
WNSS08-03-O	13.0	17.8		22.5	19.0	22.0	53.7	47.4	14.4	R3/8	57.0
WNSS10-02-O	11.0	19.4	10	20.1	14.0	18.4	47.4	45.4	17.6	R1/4	76.7
WNSS10-03-O	13.0	19.4		22.5	19.0	22.0	53.7	47.6	17.6	R3/8	84.6
WNSS10-04-O	16.5	19.4		24.9	24.0	28.0	59.3	51.0	17.6	R1/2	88.0
WNSS12-03-O	13.0	22.5	12	22.5	19.0	22.0	53.7	50.0	21.2	R3/8	85.6
WNSS12-04-O	16.5	22.5		24.9	24.0	28.0	59.3	54.1	21.2	R1/2	95.0

直通型

(mm)

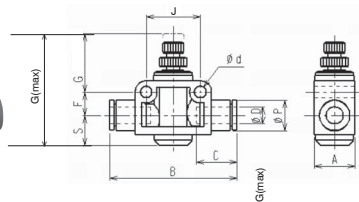
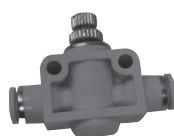

型号	A	B	C	φD	φd	F	G(max)	J	φP	S	净量 (g)
WNSF04-O	11.0	38.4	14.5	4	3.2	6.5	28.2	14.0	9.0	6.5	11.5
WNSF06-O	15.0	46.8	15.0	6	4.3	8.5	40.8	20.0	11.2	11.0	27.6
WNSF08-O	18.0	53.2	17.8	8	4.3	9.5	45.8	22.0	13.6	12.0	40.4
WNSF10-O	21.0	60.2	19.4	10	4.3	11.0	52.0	26.0	16.3	12.0	66.4
WNSF12-O	28.0	73.2	22.4	12	4.3	12.0	55.5	32.0	19.7	16.0	110.6

小型弯头型

(mm)

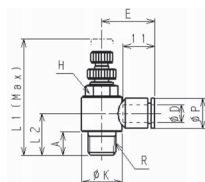

型号	A	C	φD	E	H	φK	L1 (Max)	L2	φP	R (外螺纹)	净量 (g)
WNSE-04-M3C-O	3.0	10.5	4	15.7	8.0	10.0	30.5	9.9	8.0	M3 × 0.5	6.7
WNSE-04-M5C-O	3.5	10.5		15.7	8.0	10.0	30.5	9.9	8.0	M5 × 0.8	17.5
WNSE-04-01C-O	8.0	10.5		17.8	10.0	14.0	39.8	14.3	8.0	R1/8	34.7
WNSE-06-M5C-O	3.5	11.8	6	16.7	8.0	10.0	30.5	9.9	10.4	M5 × 0.8	35.4
WNSE-06-01C-O	8.0	11.8		18.4	10.0	14.0	39.8	14.3	10.4	R1/8	63.9

周边产品

流量特性

· 控制流侧的流量 条件: 0.5MPa 时

WNSE-04-M3C-O

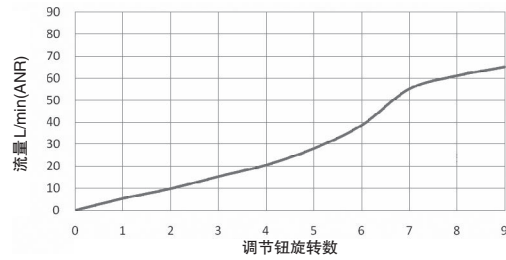

WNSE-04-M5C-O
WNSE-06-M5C-O
WNSE04-M5-O
WNSE06-M5-O
WNSS04-M5-O
WNSS06-M5-O

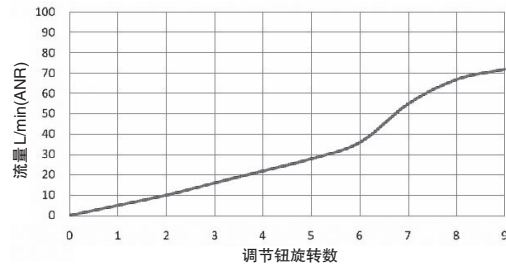

WNSE-04-01C-O
WNSE-06-01C-O
WNSE04-01-O
WNSE06-01-O
WNSE08-01-O
WNSS04-01-O
WNSS06-01-O
WNSS08-01-O

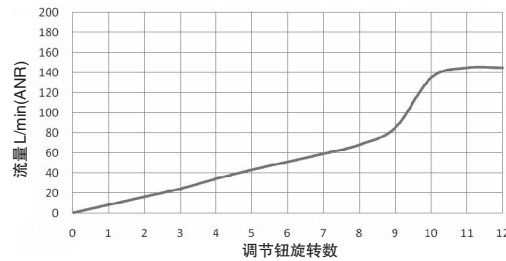

WNSE06-02-O
WNSE08-02-O
WNSE10-02-O
WNSS06-02-O
WNSS08-02-O
WNSS10-02-O

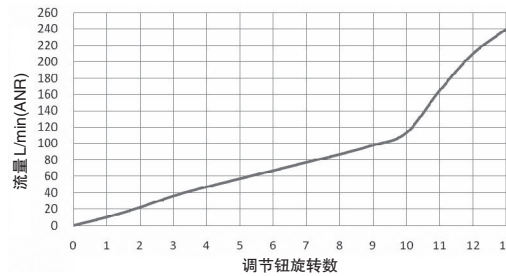

WNSE08-03-O
WNSE10-03-O
WNSS08-03-O
WNSS10-03-O
WNSE12-03-O
WNSS12-03-O

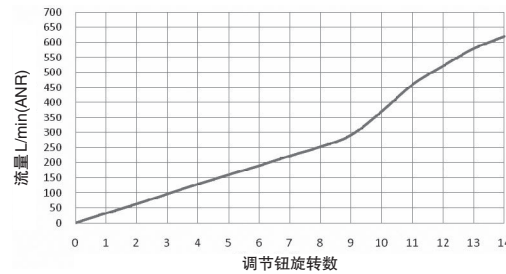

WNSE10-04-O
WNSE12-04-O
WNSS10-04-O
WNSS12-04-O

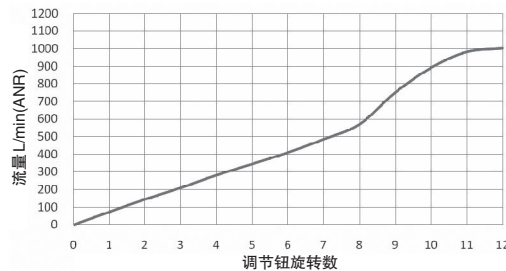

流量特性

WNSE10-04-O
 WNSE12-04-O
 WNSS10-04-O
 WNSS12-04-O

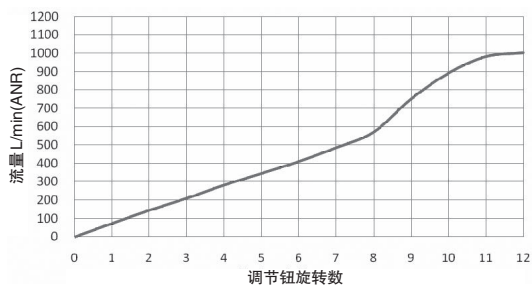

WNSF04-O

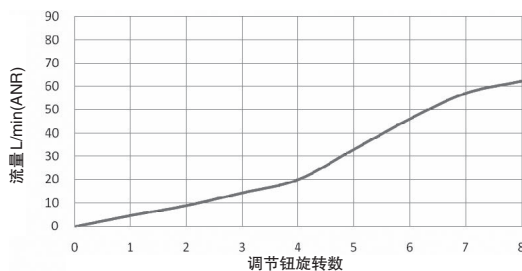

WNSF06-O

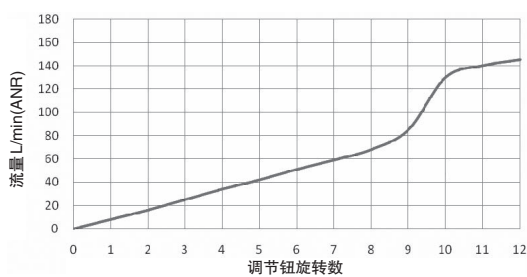

WNSF08-O

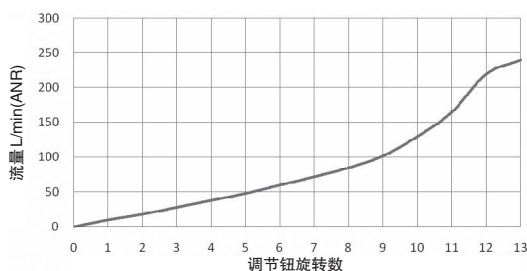

WNSF10-O

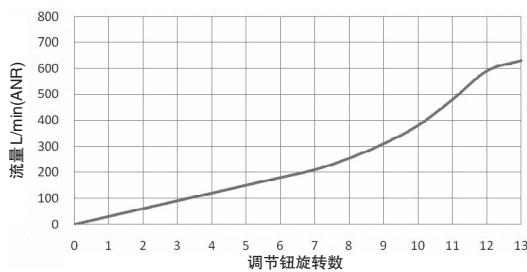

WNSF12-O

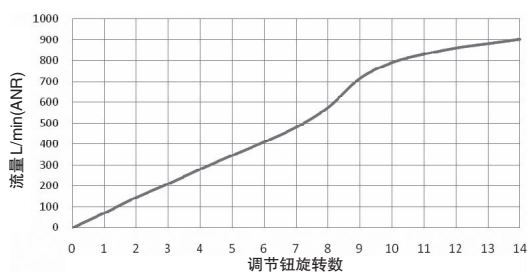

周边产品