

# Push-in connectors (compact) WP-C series

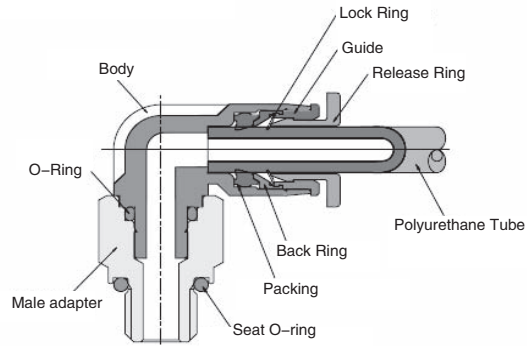
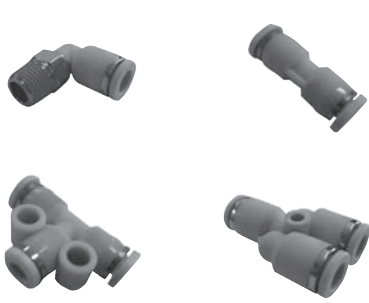

## Main Features

- ◆ Touch connector is made of only six parts.
- ◆ A newly designed lock ring assures a tight tube connection and smooth insertion.
- ◆ Tube can be inserted with light force. High airtight reliability.
- ◆ Standard flame-resistant resin material PA and F/G.

## Specifications

Description	unit	Push-in connectors
Fluid		Compressed air
Working temperature range	°C	0 ~ 60
Max. working pressure	Mpa	0 ~ 0.9
Min. working pressure	kPa	-100
Applicable tube		Polyurethane tube

Note) Working pressure value is when the temperature is 20°C .

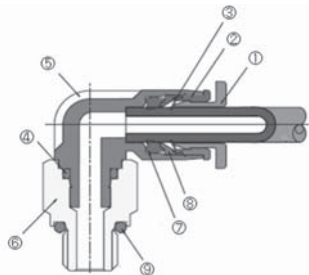

Part No.	Parts name	Material
①	Release ring	PA and F/G (Polyamid)
②	Guide	Zinc Die Casting
③	Lock ring	SUS (Stainless)
④	O-ring	NBR (Nitrile)
⑤	Body	PA and F/G (Polyamid)
⑥	Male adapter	Brass
⑦	Packing	NBR (Nitrile)
⑧	Back ring	Zinc Die Casting
⑨	Seat O-ring	NBR (Nitrile)

## How to order

10 pcs per 1 set

WPC 06 - 01 C

C : Compact type

M3 :	M3 × 0.5	M8 :	M8 × 0.75	03 :	R3/8
M5 :	M5 × 0.8	01 :	R1/8	04 :	R1/2
M6 :	M6 × 1 · M6 × 0.75	02 :	R1/4		

Applicable tube

04 :	4mm	10 :	10mm
06 :	6mm	12 :	12mm
08 :	8mm		

WPC-C :	Male connector	WPUC-C :	Union
WPCC-C :	Hexagon male connector	WPUL-C :	Union elbow
WPG-C :	Different diameter union	WPUT-C :	Union T
WPGJ-C :	Reducer	WPW-C :	Different diameter union Y
WPL-C :	Male elbow	WPWJ-C :	Different diameter branch union Y
WPLJ-C :	L type connector	WPY-C :	Union Y
WPLL-C :	Long male elbow	WPYJ-C :	Branch union Y
WPT-C :	Male branch Y		

Male connector

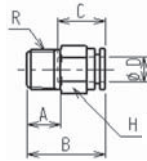

mm

Ref.	A	B	C	φD	H	R (Male)	Mass (g)
WPC04-M3C	3	15.5	10.5	4	8	M3 × 0.5	2.9
WPC04-M5C	3.5	15.7	11.5		8	M5 × 0.8	3.2
WPC04-01C	8	15	11.5		10	R1/8	6
WPC06-M5C	3.5	16.3	11.7	6	10	M5 × 0.8	3.8
WPC06-01C	8	18.5	11.7		10	R1/8	5.3

inch

Ref.	A	B	C	φD	H	R (Male)	Mass (g)
WPC04-M3C	0.12	0.61	0.41	0.16	0.31	M3 × 0.02	2.9
WPC04-M5C	0.14	0.62	0.45		0.31	M5 × 0.03	3.2
WPC04-01C	0.31	0.59	0.45		0.39	R1/8	6
WPC06-M5C	0.14	0.64	0.46	0.24	0.39	M5 × 0.03	3.8
WPC06-01C	0.31	0.73	0.46		0.39	R1/8	5.3

Male elbow

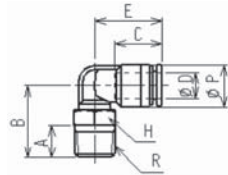

mm

Ref.	A	B	C	φD	E	H	φP	R (Male)	Mass (g)
WPL04-M3C	3	15.8	11.3	4	15.2	8	8	M3 × 0.5	3.3
WPL04-M5C	3.5	15.1	11.3		15.2	8	8	M5 × 0.8	3.3
WPL04-01C	8	16.7	11.3		15.2	10	8	R1/8	6.1
WPL06-M5C	3.5	15	11.7	6	16.5	8	10.4	M5 × 0.8	3.9
WPL06-01C	8	18	11.7		16.5	10	10.4	R1/8	6.8

inch

Ref.	A	B	C	φD	E	H	φP	R (Male)	Mass (g)
WPL04-M3C	0.12	0.62	0.44	0.16	0.6	0.31	0.31	M3 × 0.02	3.3
WPL04-M5C	0.14	0.59	0.44		0.6	0.31	0.31	M5 × 0.03	3.3
WPL04-01C	0.31	0.66	0.44		0.6	0.39	0.31	R1/8	6.1
WPL06-M5C	0.14	0.59	0.46	0.24	0.65	0.31	0.41	M5 × 0.03	3.9
WPL06-01C	0.31	0.71	0.46		0.65	0.39	0.41	R1/8	6.8

Male branch T

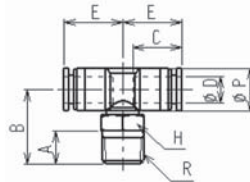

mm

Ref.	A	B	C	φD	E	H	φP	R (Male)	Mass (g)
WPT04-M5C	3.5	15.4	11.3	4	12.7	8	8	M5 × 0.8	4.1
WPT04-01C	8	17	11.3		12.7	10	8	R1/8	6.9
WPT06-M5C	3.5	16.4	11.7	6	14	8	10.4	M5 × 0.8	5.4
WPT06-01C	8	18	11.7		14	10	10.4	R1/8	8.2

inch

Ref.	A	B	C	φD	E	H	φP	R (Male)	Mass (g)
WPT04-M5C	0.14	0.61	0.44	0.16	0.5	0.31	0.31	M5 × 0.03	4.1
WPT04-01C	0.31	0.67	0.44		0.5	0.39	0.31	R1/8	6.9
WPT06-M5C	0.14	0.65	0.46	0.24	0.55	0.31	0.41	M5 × 0.03	5.4
WPT06-01C	0.31	0.71	0.46		0.55	0.39	0.41	R1/8	8.2

Long male elbow

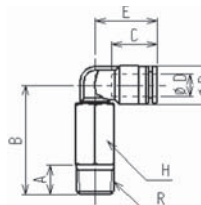

mm

Ref.	A	B	C	φD	E	H	φP	R (Male)	Mass (g)
WPLL04-M5C	3.5	25.6	11.3	4	15.2	8	8	M5 × 0.8	7.9
WPLL04-M6C	4.5	26.7	11.3		15.2	8	9	M6 × 1.0	8.3
WPLL04-01C	8	29.2	11.3		15.2	10	8	R1/8	13.2
WPLL06-M5C	3.5	25.5	11.7	6	15.5	8	10.4	M5 × 0.8	8.5
WPLL06-01C	8	29.4	11.7		16.5	10	10.4	R1/8	13.7

inch

Ref.	A	B	C	φD	E	H	φP	R (Male)	Mass (g)
WPLL04-M5C	0.14	1.01	0.44	0.16	0.6	0.31	0.31	M5 × 0.03	7.9
WPLL04-M6C	0.18	1.05	0.44		0.6	0.31	0.35	M6 × 0.04	8.3
WPLL04-01C	0.31	1.15	0.44		0.6	0.39	0.31	R1/8	13.2
WPLL06-M5C	0.14	1	0.46	0.24	0.61	0.31	0.41	M5 × 0.03	8.5
WPLL06-01C	0.31	1.16	0.46		0.65	0.39	0.41	R1/8	13.7

Push-in connectors

# WP-C

## Union

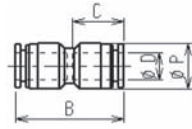

mm

Ref.	B	C	$\phi D$	$\phi P$	Mass (g)
WPUC04C	23	11.3	4	8	2
WPUC06C	24.4	11.7	6	10.4	3.2

inch

Ref.	B	C	$\phi D$	$\phi P$	Mass (g)
WPUC04C	0.91	0.44	0.16	0.31	2
WPUC06C	0.96	0.46	0.24	0.41	3.2

## Union elbow

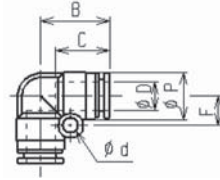

mm

Ref.	B	C	$\phi D$	$\phi d$	F	$\phi P$	Mass (g)
WPUL04C	13.5	11.3	4	3.2	5.8	8	2.1
WPUL06C	15	11.7	6	3.2	6.5	10.4	3.4

inch

Ref.	B	C	$\phi D$	$\phi d$	F	$\phi P$	Mass (g)
WPUL04C	0.53	0.44	0.16	0.13	0.23	0.31	2.1
WPUL06C	0.59	0.46	0.24	0.13	0.26	0.41	3.4

## Male branch T

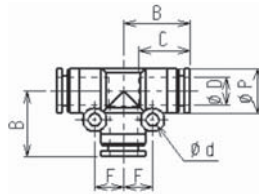

mm

Ref.	B	C	$\phi D$	$\phi d$	F	$\phi P$	Mass (g)
WPUT04C	13.5	11.3	4	3.2	5.8	8	3.1
WPUT06C	15	11.7	6	3.2	6.5	10.4	5

inch

Ref.	B	C	$\phi D$	$\phi d$	F	$\phi P$	Mass (g)
WPUT04C	0.53	0.44	0.16	0.13	0.23	0.31	3.1
WPUT06C	0.59	0.46	0.24	0.13	0.26	0.41	5

## Reducer

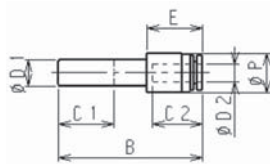

mm

Ref.	B	C1	C2	$\phi D1$	$\phi D2$	E	$\phi P$	Mass (g)
WPGJ06-04C	32.7	12.5	11.3	6	4	12.7	9	1.8

inch

Ref.	B	C1	C2	$\phi D1$	$\phi D2$	E	$\phi P$	Mass (g)
WPGJ06-04C	1.29	0.49	0.44	0.24	0.16	0.5	0.35	1.8

## L type connector

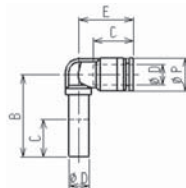

mm

Ref.	B	C	$\phi D$	E	$\phi P$	Mass (g)
WPU04C	23.5	11.3	4	15.2	8	2
WPU06C	25.2	11.7	6	16.5	10.4	2.6

inch

Ref.	B	C	$\phi D$	E	$\phi P$	Mass (g)
WPU04C	0.93	0.44	0.16	0.6	0.31	2
WPU06C	0.99	0.46	0.24	0.65	0.41	2.6

Union Y

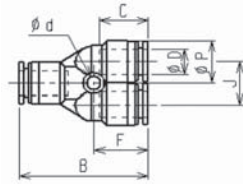

mm

Ref.	B	C	φD	φd	F	J	φP	Mass (g)
WPY04C	29.3	11.3	4	3.2	12.9	8.2	8.2	3.4
WPY06C	31.4	11.7	6	3.2	13.2	10.5	10.4	5.3

inch

Ref.	B	C	φD	φd	F	J	φP	Mass (g)
WPY04C	1.15	0.44	0.16	0.13	0.51	0.32	0.32	3.4
WPY06C	1.24	0.46	0.24	0.13	0.52	0.41	0.41	5.3

Branch union Y

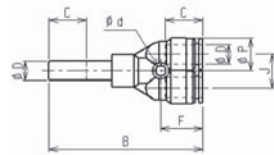

mm

Ref.	B	C	φD	φd	F	J	φP	Mass (g)
WPYJ04C	45	11.3	4	3.2	12.9	8.2	8.2	3.5
WPYJ06C	48.4	11.7	6	3.2	13.2	10.5	10.4	5.5

inch

Ref.	B	C	φD	φd	F	J	φP	Mass (g)
WPYJ04C	1.77	0.44	0.16	0.13	0.51	0.32	0.32	3.5
WPYJ06C	1.91	0.46	0.24	0.13	0.52	0.41	0.41	5.5

Different diameter union

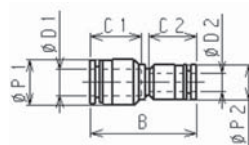

mm

Ref.	B	C1	C2	φD1	φD2	φP1	φP2	Mass (g)
WPG0604C	24.1	11.7	11.3	6	4	10.4	8	2.5

inch

Ref.	B	C1	C2	φD1	φD2	φP1	φP2	Mass (g)
WPG0604C	0.95	0.46	0.44	0.24	0.16	0.41	0.31	2.5

Different diameter union Y

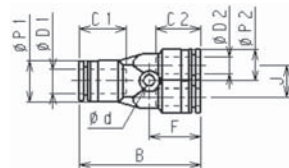

mm

Ref.	B	C1	C2	φD1	φD2	φd	F	J	φP1	φP2	Mass (g)
WPW06-04C	30.7	11.7	11.3	6	4	3.2	12.9	8	10.4	8	4.1

inch

Ref.	B	C1	C2	φD1	φD2	φd	F	J	φP1	φP2	Mass (g)
WPW06-04C	1.21	0.46	0.44	0.24	0.16	0.13	0.51	0.31	0.41	0.31	4.1

Different diameter branch union Y

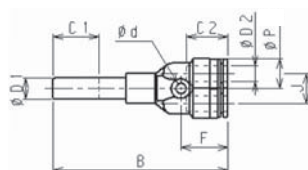

mm

Ref.	B	C1	C2	φD1	φD2	φd	F	J	φP	Mass (g)
WPWJ06-04C	47.8	12.5	11.3	6	4	3.2	12.9	8.2	8.2	4.2

inch

Ref.	B	C1	C2	φD1	φD2	φd	F	J	φP	Mass (g)
WPWJ06-04C	1.88	0.49	0.44	0.24	0.16	0.13	0.51	0.32	0.32	4.2